



SKY CARAVANS

WHOLE YEAR MOBILE HOME MANUFACTURER

MOBILE HOME PORTO

12.0 x 4.0m

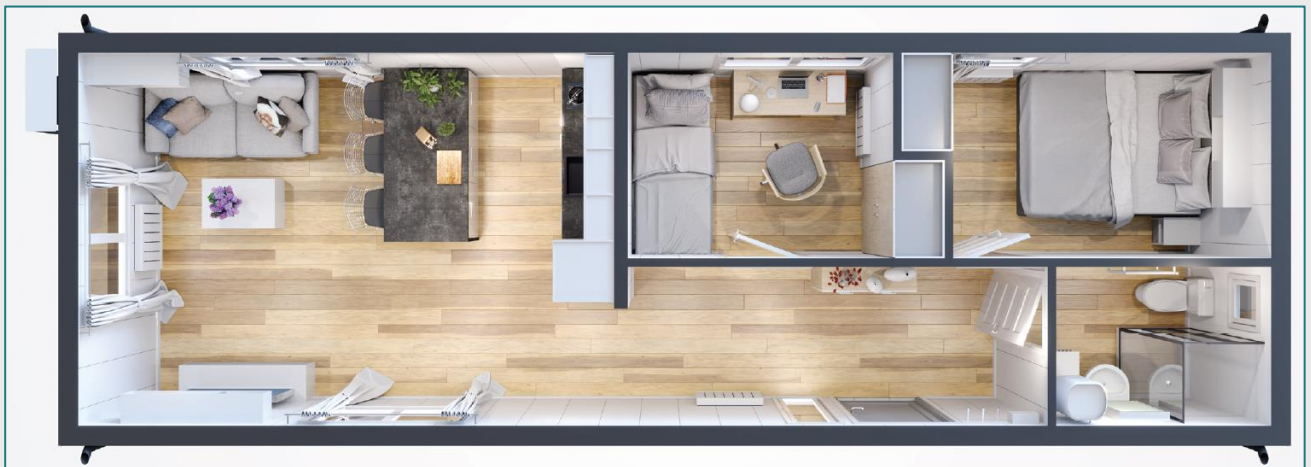

01 LIVING ROOM

- SOFA BED
- COFFEE TABLE
- HANGING CABINET
- TV CABINET
- SPACE FOR TV/ANTENNA SOCKET
- SPACE FOR AIR CONDITIONING
- ELECTRIC HEATER

02 KITCHEN

- KITCHEN CABINETS
- KITCHEN TABLE TOP
- KITCHEN ISLAND
- BUILT-IN FRIDGE
- 2 RING ELECTRIC PLATE
- SINK
- SPACE FOR OVEN
- SPACE FOR DISHWASHER
- TELESCOPIC HOOD

03 BATHROOM

- SHOWER CABINET
- SINK WITH CUPBOARD
- HANGING CABINET WITH MIRROR
- WC
- SPACE FOR WASHING MACHINE
- ELECTRIC HEATER
- BOILER 55 L

04 BEDROOM 1

- DOUBLE BED
- WARDROBE
- BEDSIDE TABLE
- HANGING CABINET
- ELECTRIC HEATER

05 BEDROOM 2

- SINGLE BED
- DESK
- ELECTRIC HEATER
- WARDROBE

06 HALLWAY

- MAIN SWITCHBOX
- HANGER
- DRAWER TABLE
- ELECTRIC HEATER



MAKE THE PROJECT ADJUSTABLE TO THE PLOT

For each project we have adjustable version with minor image



SELECTION OF FINISHING ELEMENTS

For more information, please contact our Sales Department



ADDITIONAL EQUIPMENT

The customer has influence on the choice of wall, floor and facade finish of the mobile home.



INDIVIDUAL PROJECT

It is possible to design a mobile home according to your own idea.

FEATURES	BASIC	COMFORT
EXTERNAL DIMENSIONS	12 x 4 m (48m2)	
USABLE AREA	40,9 m2 (living room with a kitchenette 18,8 m2, hallway 6,5 m2, bedroom 1: 6,7 m2, bedroom 2: 5,7 m2, bathroom 3,2 m2)	
WEIGHT	10 ton	
ROOM HEIGHT	225 cm	
SLEEPING PLACES	5/6	
CONSTRUCTION	Skeleton steel frame with wooden elements, based on structural design with two rigid axes. Drawbar can be moved from front to rear to move the mobile home. The model has 8 support points.	
FLOOR	In addition to steel construction elements, galvanized sheet metal, open cell foam PUR 13 cm , wooden substructure, OSB board, PVC lining or floor panels.	
ROOF	In addition to steel construction elements, wooden substructure, open-cell foam PUR 13 cm , highly vapour-permeable membrane, matt sheet metal roofing tile.	
EXTERNAL WALLS	The elevation is finished with siding. In addition to steel construction elements, wooden substructure, OSB board, open cell foam PUR 13 cm , wind protection membrane and vapour barrier foil, anti-rodent protection.	
INTERNAL WALLS	Wooden construction, OSB board, PVC or MDF panel.	
DOORS	External door 90/200 cm single-leaf steel, insulated, 48 mm thick. Interior door 70/200 cm white MDF or wooden.	
WINDOWS	5-chamber system, depth of installation 70mm, two-pane package with steel frame,PVC profile in white with ventilators.	
GUTTERING	Steel gutters and drain pipes.	
ELECTRIC INSTALLATION	Main switchgear, single-phase or 3-phase installation to choose from. Electrical cables in the cable duct. To sockets 3x2.5mm ² cable, to lighting 3x1.5mm ² . Inside electrical sockets, antenna sockets (x1) and switches. Outside there is a double socket on the facade and a single socket under the house.	
WATER AND SEWAGE SYSTEM	In the kitchen and bathroom made of ALU-PEX and PVC pipes. Hidden in the walls and led out under the house to be connected to the grid.	
VENTILATION	Roof space ventilation, sanitary system ventilation. In rooms, exhaust ventilation (exhaust ventilation) with a wall fan located in the bathroom and ventilators located in the windows.	
INSIDE LIGHTING	Ceiling lighting in the form of LED points in every room.	
OUTSIDE LIGHTING	Power supply for external lighting points (x2).	
HEATING	Oil-fired electric radiators with thermostat and ribbed electric radiators in the bathroom.	
HALLWAY	Main switchbox, clothes hanger, drawer table	
LIVING ROOM	Room prepared for furnishing	Sofa bed, coffee table, hanging cabinets, TV cabinet.
BATHROOM	Electrical and hydraulic system prepared for valve installation, installation for washing machine.	Square shower cabinet 80x80cm, hanging cabinet with mirror, washbasin with cabinet, WC, boiler 55 L.
KITCHEN	Electric and hydraulic installation prepared for the installation of kitchen furniture and equipment.	Kitchen furniture, kitchen island, kitchen table top, built-in fridge, 2-burner hob, sink, telescopic hood with an outlet to the outside, space for oven and dishwasher.
BEDROOM 1	Room prepared for furnishing	Double bed 160/200 cm with a container for bedding and a spring mattress, bedside table, hanging cabinet, wardrobe.
BEDROOM 2	Room prepared for furnishing	Single bed 80/200 cm with a container for bedding and a spring mattress, desk, wardrobe.